

Greenbank Road

GREENBANK

APPROXIMATE FLOOR AREA
70.3 SQM / 757 SQFT



GROUND FLOOR
374 sq.ft. (34.7 sq.m.) approx.

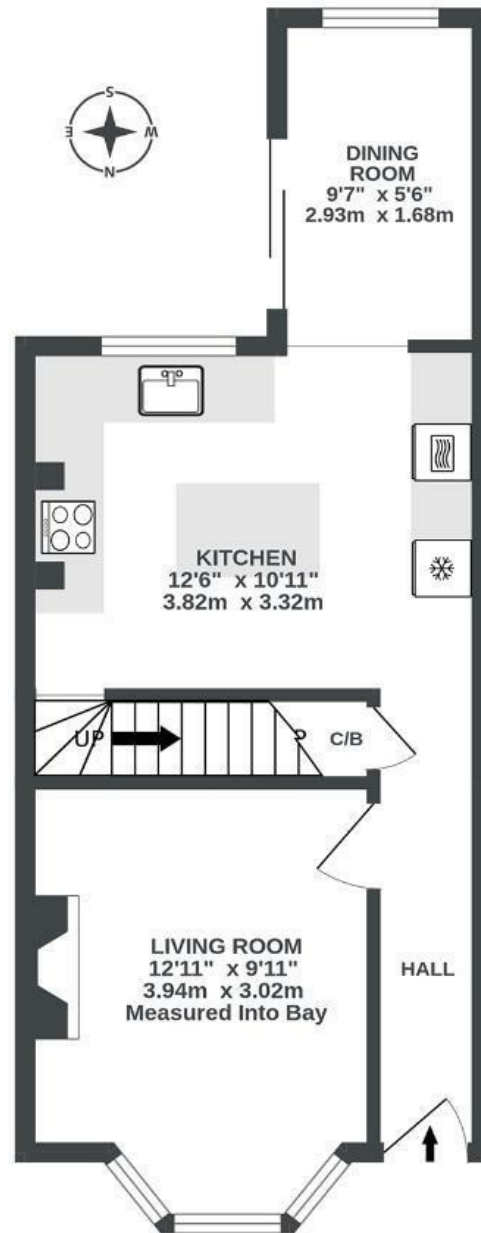

1ST FLOOR
383 sq.ft. (35.6 sq.m.) approx.



Illustrations are for reference purposes only, measurements are approximate, not to scale.

Boardwalk

Greenbank Road

GREENBANK, BRISTOL

£

£400,000

zzz

2 Bedrooms



BS5 6EY



1 Bathrooms

We've loved hosting friends in the cosy dining space, enjoying candle-lit dinners, as well as parties and BBQs in the garden. The garden is a real sun trap, and we've spent many summer evenings out on the decking – hosting BBQs, watching the Euros final. We also love having The Greenbank at the end of the road for an impromptu pint, and often head down to our favourite Nol2 café, home to one of the best bacon butties around.'

